

Construction Notice – Electrical Upgrade Work Fraser Highway at 184 Street, Surrey

February 7, 2025

We're working closely with the Surrey Langley SkyTrain Project team to accommodate the rapid transit extension from Surrey to Langley. This work includes the installation of a duct bank to accommodate the relocation of power lines from the north side of Fraser Highway to the south side.

A duct bank is a series of plastic conduits encased in concrete that house and protect underground cables.

Where: Fraser Highway west of 184 Street in Surrey.

When: Anticipated to start February 10 with targeted completion by mid-February.

Working Hours: Monday to Saturday from 7 a.m. to 7 p.m.

This work requires temporary traffic pattern changes. Traffic will be reduced to a single lane, in each direction along Fraser Highway.

- Access to Ben's Farm and Garden Center from Fraser Highway will be intermittent (see map on page 2).
- Access to 184 Street from Fraser Highway will be maintained (see map on page 2).

Safety is our top priority. Sidewalks, bike lanes and bus stops on this route will be impacted and may not be available. Please follow the onsite signage provided by TransLink and the direction of the crew on site.

Drivers are advised to plan ahead and expect delays. Please reduce speed in the construction zone and follow the directions of traffic control personnel and posted signage. Cyclists are advised to look for [alternative bike routes](#) while the work is underway along Fraser Highway. <https://www.surrey.ca/cycling>

If you have any questions or would like more information about our work to relocate the power lines and equipment, please contact us at 1-866-647-3334. Look for additional updates at www.bchydro.com/skytrain.

For inquiries directly related to the SkyTrain extension project, please contact surreylangleyskytrain@gov.bc.ca

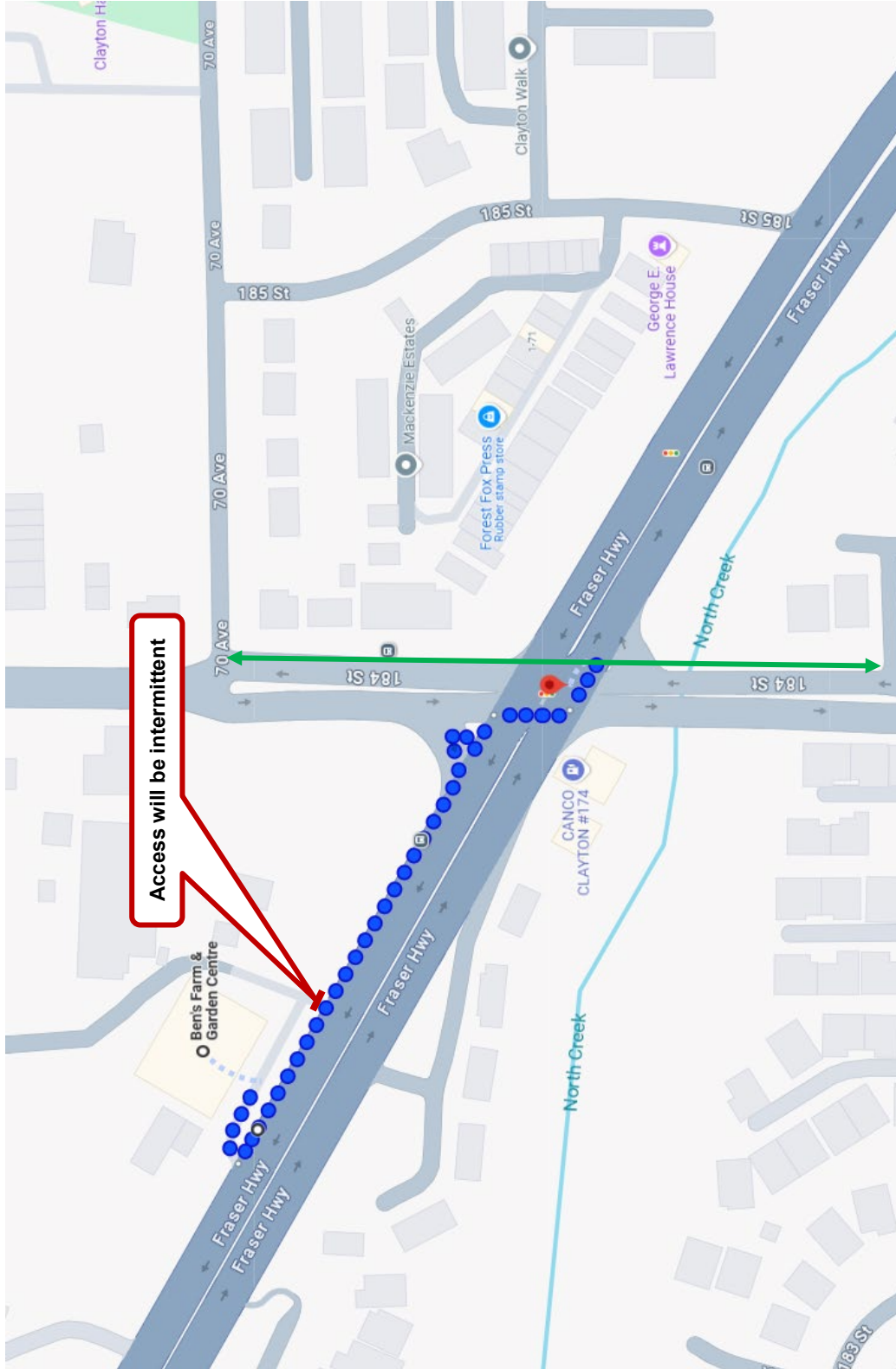

Legend:

- Work Zone. (Blue line)
- Access Intermittent. (Red line)
- Access/Detour Available. (Green line)

Above: The work zone for duct bank work on Fraser Highway at 184 Street in Surrey is highlighted in blue.